



*spraymastertech.com*



300-2969 For Non-Central Systems

PRODUCT: \_\_\_\_\_

SKU NUMBER: \_\_\_\_\_

QUANTITY: \_\_\_\_\_

#### FEATURES

- 10" brush with flow-through head
- 90° shut-off Valve
- •47" Overall Length
- •36" Aluminum Lance
- •Stainless Steel Ball Valve
- •Shut-Off or Flow-Thru, Quick Connect Socket
- •10" Brush Head with Nylon Bristles

SMT - Wall and Tile Brush

**Spray Master Technologies®**

**TOLL FREE: 800-548-3373**

115 E. Linden • Rogers, Arkansas 72756 USA  
(479) 636-5776 • Fax: (479) 636-3245

[www.spraymastertech.com](http://www.spraymastertech.com)



SMT - Wall and Tile Brush

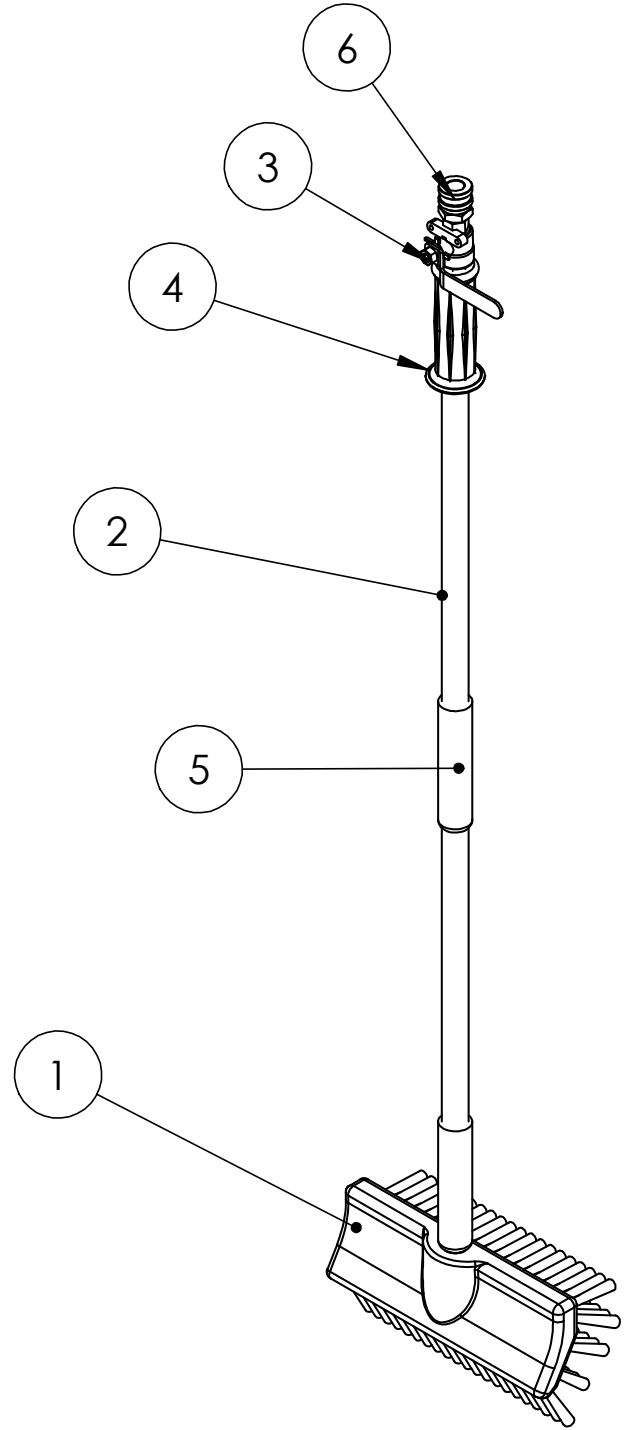

| Seq | Material | WC    | Material Description                   | Quantity | U/M |
|-----|----------|-------|--|----------|-----|
| 1   | 300-2954 | 2SUB2 | Brush,10" Wall & Tile,F-T,Tiff         | 1        | EA  |
| 2   | 300-2955 | 2SUB2 | Lance , 36 Alum, 3/8 Mpt X Acme Thread | 1        | EA  |
| 3   | 300-1400 | 2SUB2 | Valve,Ball,3/8" FM x 3/8" FM 3/16-24   | 1        | EA  |
| 4   | 300-2939 | 2SUB2 | Grip,7/8"X5" W/Flange,Black            | 1        | EA  |
| 5   | 300-2938 | 2SUB2 | Grip,7/8X5,W/O Flange,Black,Rub        | 3        | EA  |
| 6   | 300-0408 | 2SUB2 | Socket,QC,F-T,3/8" SS                  | 1        | EA  |